



2025

SURVEYORS' Conference

AGENDA

Sunday, January 12

- 3:00PM – 5:00PM..... EXHIBITOR REGISTRATION (*OUTSIDE OF EXHIBIT HALL*)
- 4:00PM – 6:00PM.....REGISTRATION OPEN (*CONFECTION HALL OFFICE*)
- 5:00PM – 7:30PM..... EXHIBITS OPEN (*EXHIBIT HALL*)
- 5:00PM – 9:00PM.....SOCIAL GATHERING (*EXHIBIT HALL*)

Monday, January 13

- 7:00AM – 5:30PM.....REGISTRATION (*CONFECTION HALL OFFICE*)
- 7:00AM - 8:15AM.....BREAKFAST (*EXHIBIT HALL*)
- 7:00AM - 5:45PM.....EXHIBITS OPEN (*EXHIBIT HALL*)
- 8:15AM – 11:45AM.....CONCURRENT SESSIONS
 - 101: The Report of Survey - A Narrative Approach.....CRYSTAL A
 - 201: Cultivating the Next Generation.....WILD ROSE B
 - 301: Survey Data Workflows with Autodesk Civil3D.....EMPIRE AB
 - 401: Bridge & Structural Surveys.....EMPIRE CD
- 8:15AM - 9:45AM.....CONCURRENT SESSIONS
 - 501: The Pennsylvania - Delaware Arc Boundary.....MAGNOLIA AB
 - 601: Engineer, Land Surveyor and Geologist Registration Law.....MAGNOLIA CD
 - 701: Reducing Liability in the Work Zone.....WILD ROSE A
 - 801: Hydrographic Surveys: Surveying Small Bodies of Water Using an Unmanned Small Vessel...AZTEC ROOM
- 10:15AM - 11:45AM.....CONCURRENT SESSIONS
 - 502: West Virginia - Pennsylvania - Ohio North-South Line.....MAGNOLIA AB
 - 602: Digital Signatures, Seals and Datasets.....MAGNOLIA CD
 - 702: Ensuring Safe & Effective Utility Access in Confined Spaces: Best Practices & Innovations.....WILD ROSE A
 - 802: Railroads.....AZTEC ROOM
- 11:45AM - 1:00PM.....LUNCH (*EXHIBIT HALL*)
- 1:00PM – 4:30PM.....CONCURRENT SESSIONS
 - 302: Surface Modeling with Autodesk Civil3D.....EMPIRE AB
 - 603: Engineering Land Surveys per the Registration Act # 367.....MAGNOLIA CD
 - 703: Keeping Consultants on Track - A Discussion on Working with Railroads.....WILD ROSE A
 - 803: Geodesy Review with Discussion of NATRF2022 and SPCS2022.....EMPIRE CD
- 1:00PM – 2:30PM.....CONCURRENT SESSIONS
 - 102: Deed & Plan Research: When is Enough Enough?.....AZTEC ROOM
 - 202: Discussion Panel - Navigating Onboarding and Training: Insights from Surveyors.....MAGNOLIA AB
 - 402: The Topographic Survey.....WILD ROSE B
 - 503: Presidential Surveyors-The Surveying Work of George Washington, Thomas Jefferson & Abraham Lincoln.....CRYSTAL A

 **Hershey, PA**





Monday, January 13 Continued...

- 3:00PM – 4:30PM.....CONCURRENT SESSIONS**
- 103: Documentation of Boundary Evidence.....AZTEC ROOM
 - 203: Effective Project Management for Surveyors and Design Professionals.....MAGNOLIA AB
 - 403: Preparing for and Attending Municipal Meetings.....WILD ROSE B
 - 504: Monumental Surveyors - Surveying for Monumental Carvings at Stone Mountain, Mount Rushmore, and Crazy Horse.....CRYSTAL A
- 5:00PM - 5:45PM.....RECEPTION & NETWORKING (EXHIBIT HALL)**
- 6:00PM - 8:15PM.....DINNER & EVENING PROGRAM (EXHIBIT HALL)**
(AWARDS & SWEARING-IN OF OFFICERS/GENERAL MEMBERSHIP MEETING)
- 8:15PM - 10:30PM.....MEMBER APPRECIATION PARTY (COCOA BALLROOM)**

Tuesday, January 14

- 7:00AM – 5:30PM.....REGISTRATION (CONFECTION HALL OFFICE)**
- 7:00AM - 8:15AM.....BREAKFAST (EXHIBIT HALL)**
- 7:00AM - 5:45PM.....EXHIBITS OPEN (EXHIBIT HALL)**
- 8:15AM – 11:45AM.....CONCURRENT SESSIONS**
- 104: Art of Boundary Line Determination.....AZTEC ROOM
 - 303: Optimizing Field Data Collection Combining GNSS and Total Station Data Using Carlson Software.....MAGNOLIA AB
 - 404: FEMA Elevation Certificates.....EMPIRE CD
 - 604: Overview of the Standards of Practice for Professional Land Surveyors in Pennsylvania.....CRYSTAL A
- 8:15AM – 9:45AM.....CONCURRENT SESSIONS**
- 204: Surveying and Mapping Guidelines for Transportation Projects.....MAGNOLIA CD
 - 505: Urban Surveying.....EMPIRE AB
 - 804: CURSES?! #%&; No. Cursive.....WILD ROSE B
- 10:15AM – 11:45AM.....CONCURRENT SESSIONS**
- 205: Surveyor Communications.....WILD ROSE B
 - 506: Riparian Boundaries.....MAGNOLIA CD
 - 805: Survey Terminology.....EMPIRE AB
- 11:45AM - 1:00PM.....LUNCH (EXHIBIT HALL)**
- 1:00PM – 4:30PM.....TUESDAY AFTERNOON CONCURRENT SESSIONS**
- 105: ALTA/NSPS Land Title Surveys and The Complementary Nature of Title Reports.....AZTEC ROOM
 - 304: From Drone...To Field... To Finish... with Carlson Software.....MAGNOLIA AB
 - 405: Floodplain Analysis to establish Base Flood Elevation (BFE) for a Zone A Stream.....EMPIRE CD
 - 507: Using Reality Capture to Preserve Ancient Structures.....CRYSTAL A
 - 605: How to Comply with the Standards of Practice.....MAGNOLIA CD





2025
SURVEYORS'
Conference

Tuesday, January 14 continued...

- 1:00PM – 2:30PM.....CONCURRENT SESSIONS**
- 206: Technical Nature for Sound Client Management.....WILD ROSE B
 - 704: Stop the Bleed.....WILD ROSE A
 - 806: Take Flight – Part 1: Understanding the Technology, Applications, and Regulations.....EMPIRE AB
- 3:00PM – 4:30PM.....CONCURRENT SESSIONS**
- 207: Technical Elements of Working with Other Design Professionals.....WILD ROSE B
 - 705: Ouch! Basic First Aid and Trauma Care for the Land Surveyor.....WILD ROSE A
 - 807: Take Flight – Part 2: Profiting from Deliverables, Understanding the Challenges, & Learning from Case Studies of UAS.....EMPIRE AB
- 5:00PM - 5:45PM.....RECEPTION & NETWORKING (EXHIBIT HALL)**
- 6:00PM - 8:30PM.....DINNER & EVENING PROGRAM (RAFFLE & AUCTION) (EXHIBIT HALL)**

Wednesday, January 15

- 7:00AM – 11:45AM.....REGISTRATION (CONFECTION HALL OFFICE)**
- 7:00AM - 8:15AM.....BREAKFAST (EXHIBIT HALL)**
- 8:15AM – 11:45AM.....CONCURRENT SESSIONS**
- 106: Writing Legal Descriptions.....EMPIRE CD
 - 606: Ethics for the Geomatics Professional.....WILD ROSE B
- 8:15AM – 9:45AM.....CONCURRENT SESSIONS**
- 208: Engaging and Developing a Dispersed Workforce.....WILD ROSE A
 - 406: Deformation Monitoring-Field.....MAGNOLIA CD
 - 508: Vertical Datums and Heights.....MAGNOLIA AB
 - 706: The Practical and Legal Aspects of Property Access (Right of Entry) for Surveyors in PA.....AZTEC ROOM
 - 808: GIS for Surveyors (Part 1).....EMPIRE AB
- 10:15AM – 11:45AM.....CONCURRENT SESSIONS**
- 407: Deformation Monitoring-Office.....MAGNOLIA CD
 - 509: Using OPUS and OPUS Projects.....MAGNOLIA AB
 - 707: Pennsylvania Gun Laws.....AZTEC ROOM
 - 809: GIS for Surveyors (Part 2).....EMPIRE AB
- 11:45AM.....ADJOURNMENT**

 **Hershey, PA**





2025

SURVEYORS' *Conference*

GUEST PROGRAM

Monday, January 13, 2025

- 9:00am - 10:30am.....Breakfast at hotel (Tower Suite 2)
- 10:30am - 11:30am.....Bingo games at hotel (Tower Suite 2)
- 11:45am - 1:00pm.....Lunch at hotel (Exhibit Hall)
- 1:20pm.....Meet in hotel lobby for historic trolley tour and Chocolate World
- 1:45pm - 3:45pm.....Historic trolley tour and Chocolate World
- *Performing trolley conductors take center stage and delight their audience with an in-depth and remarkable look at the Hershey of today and years past. Throughout the entire show, you will be tasting the chocolate that made Mr. Hershey famous! The trolley tour is 1 hour and 15 minutes. After the trolley tour, walk around Chocolate World - go to the gift shop or go on the free ride chocolate tour ride.*
- 3:45pm.....Return to hotel
- 5:00pm - 10:30pm.....Reception, Dinner, Evening Program, Member Appreciation Party

Tuesday, January 14, 2025

- 8:30am - 9:30am.....Breakfast at hotel (Tower Suite 2)
- 10:45am.....Meet in hotel lobby for Orchid Tour & lunch out
- 11:00am - 11:55am.....Orchid Tour in Butterfly Atrium and Explore Hershey Gardens
- *Enjoy a guided tour and learn about orchid species and orchid care while walking among the hundreds of butterflies. The orchid tour is about 30 minutes. Then walk around Hershey Gardens and/or go to the gift shop.*
- 12:00pm - 1:15pm.....Lunch out at Smoked Grill
- 1:30pm.....Return to hotel
- 5:00pm - 8:30pm.....Reception, Dinner, Evening Program (Exhibit Hall)

 **Hershey, PA**





2025

SURVEYORS' Conference

Exhibit Hall is located in the White/Blue room of the Great American Hall on the main level

Tower Level

Main Level

KEY	
	Business Center
	Restrooms
	Telephone
	ATM

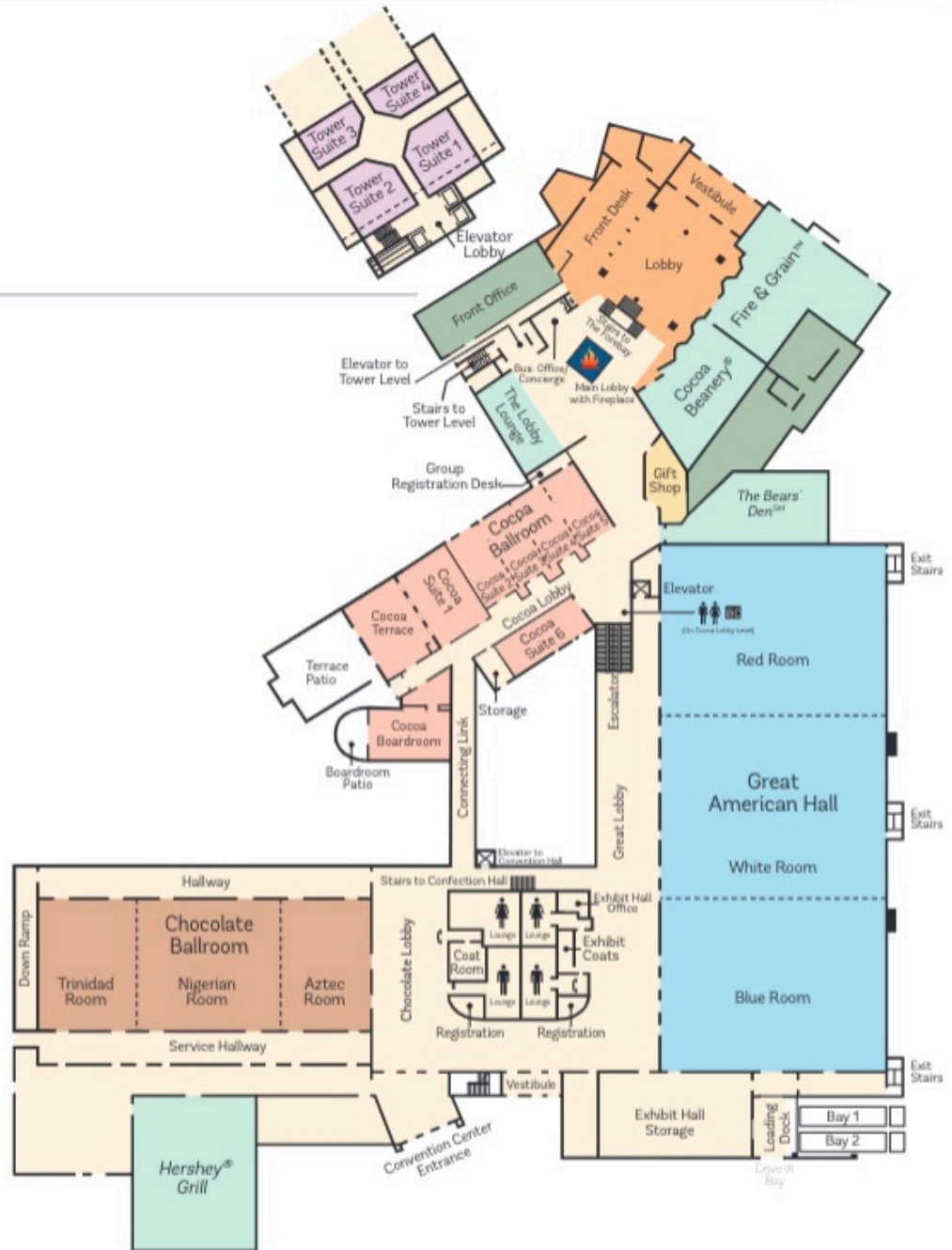

Confection Hall Level

